

APPLICATIONS		REVISIONS			
NEXT ASSEMBLY	USED ON	REV.	DESCRIPTION	DATE	APPROVED
		A	RELEASED TO PRODUCTION	11-09-11	JAA

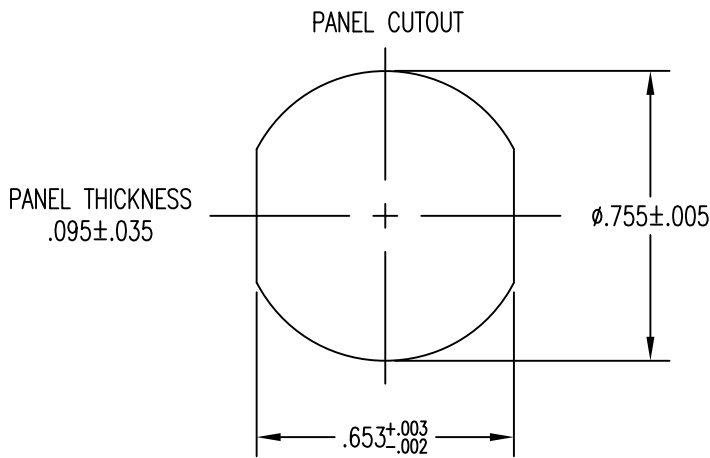
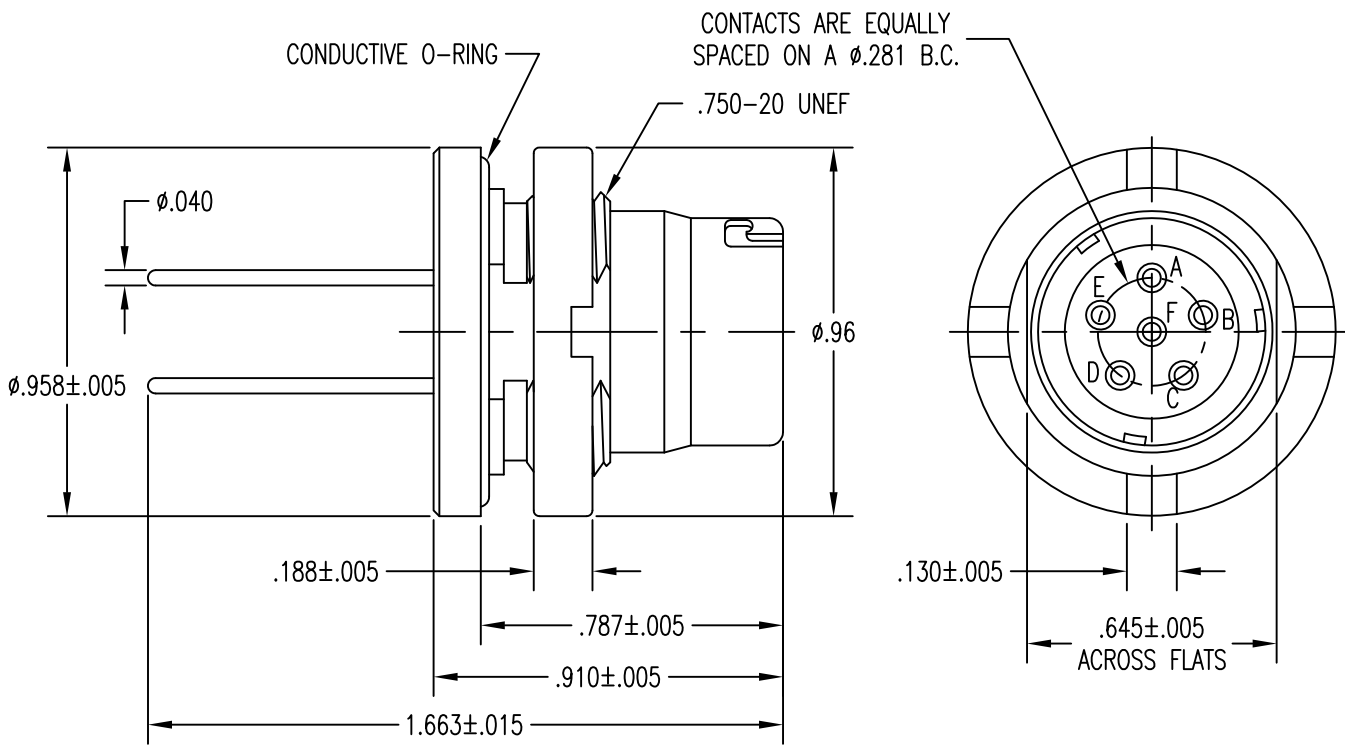

FILE NAME: MC775N-16.dwg

UNLESS OTHERWISE SPECIFIED
DIMENSIONS ARE IN INCHES
TOLERANCES ARE:

FRACTIONS	DECIMALS	ANGLES
$\pm 1/64$.XX \pm .01	$\pm 1/2^\circ$
	.XXX \pm .003	

CONTRACT NO.	
APPROVALS	DATE

MIL-CONTM
AN AFFILIATE OF THE PHOENIX COMPANY OF CHICAGO

MC775N-16 AUDIO CONNECTOR

THE INFORMATION DISCLOSED IN
THIS DOCUMENT IS CONFIDENTIAL
AND PROPRIETARY TO MIL-CON,
INC. AND MAY NOT BE USED FOR
MANUFACTURE OR ANY OTHER
PURPOSE WITHOUT THE WRITTEN
CONSENT OF MIL-CON, INC.

DRAWN	J. Abrell	09/14/11
CHECKED	A. Huevo	11/11/11
ISSUED		

SIZE	FSCM NO.	DWG. NO.	REV.
A	63525	SD: MC775N-16	A

DO NOT SCALE DRAWING

SCALE NONE SHEET 1 OF 2

SPECIFICATIONS:

- 1) MATERIALS:
SHELL AND PANEL NUT: STAINLESS STEEL (CLASS 304)
CONTACTS (REAR): COPPER ALLOY
CONTACTS (FRONT): BERYLLIUM COPPER
INSULATOR: DIALLYL PHTHALATE PER MIL-M-14. TYPE MDG
O-RING: CONDUCTIVE SILICONE
- 2) FINISH/COLOR:
SHELL AND PANEL NUT: PASSIVATED, SAND BLASTED
CONTACTS (REAR): 0.000030 GOLD PER MIL-G-45204, TYPE II, CLASS 0;
OVER 0.000100 NICKEL PER QQ-N-290
CONTACTS (FRONT): 0.000100 GOLD PER MIL-G-45204, TYPE II, CLASS 1;
OVER 0.000100 NICKEL PER QQ-N-290
INSULATOR: BLUE
- 3) ELECTRICAL PROPERTIES:
OPERATING VOLTAGE: 60 VOLTS MAXIMUM POTENTIAL
CURRENT RATING: 0.5 AMPS MAXIMUM
DIELECTRIC BREAKDOWN: 500 VOLTS RMS
INSULATION RESISTANCE: 1000 MEGOHMS MINIMUM
CONTACT RESISTANCE: 0.040 OHMS MAXIMUM FROM 1 TO 1500 MATINGS
0.100 OHMS MAXIMUM FROM 1500 TO 3000 MATINGS
1.000 OHMS MAXIMUM AFTER 3001 MATINGS
- 4) MECHANICAL PROPERTIES:
AIR PRESSURE: 3.0 P.S.I.
DURABILITY: 3000 CYCLES, MATE AND UNMATE
OPERATING TEMPERATURE: -52°C TO +95°C
WATER IMMERSION: 48 HOURS AT 6 FEET
- 5) MC775N-16 RECEPTACLE MATES WITH:
ON190305 - ALL VERSIONS
ON241774 - ALL VERSIONS
- 6) DIMENSIONS ARE FOR REFERENCE ONLY, UNLESS OTHERWISE SPECIFIED

MIL-CON TM	FILE NAME: MC775N-16.dwg			
	SIZE	FSCM NO.	DWG. NO.	REV.
	A	63525	SD: MC775N-16	A
DRAWN J. Abrell	SCALE	NONE	SHEET 2	OF 2
ISSUED				